



AUTOGUIDE EQUIPMENT



POLE JACK AND FOOT PEDAL UNIT

MANUAL SPARE PARTS

Autoguide Equipment Ltd
Stockley Road,
Heddington, Calne,
Wiltshire, UK,
SN11 0PS
+44(0)1380 850885
www.autoguide.co.uk



Published: 15 March 2023
ID: M058 1.3

These instructions give safety and operations information regarding the use of Handheld Powerhead supplied by Autoguide Equipment. They contain the relevant information for products:

Product Code	Description	Maximum Pressure (Bar)	Maximum Flow (L/m)
49235	Foot Pedal	200	30
50796	Pole Jack	200	30

To ensure optimum results when operating this equipment it is very important to read this manual carefully, the information will prepare you to do a better, safer job.

Before operating the machine you should familiarise yourself with the instructions in this manual. Incorrect use can lead to damage which is not covered by the Warranty Conditions. This may create a dangerous situation or lead to unsatisfactory results.

These operating instructions **MUST** always be made available to the person or persons operating this equipment.

To assist in the ordering of spares, or other communications with our company, the serial number of the relevant equipment supplied, has been recorded below for your information.

Model No:-

Serial No:-

Date of Delivery:-

CONTENTS

- Information3
 - Safety Instructions3
 - Description.....4
 - Important Notes4
- Operation Of the Pole Jack5
 - Operating Instructions.....5
- Using the Pole Jack with the Foot Pedal9
 - Assembly9
 - Operating Instructions.....10
- Troubleshooting11
- End of Life12
- Spare Parts List.....13
 - 50796 - Pole Jack.....13
 - 49235 – Foot Pedal Assembly14
 - 49236 – Foot Pedal Hydraulic Assembly15

INFORMATION

Your Pole Jack and Foot Pedal has been individually built with great emphasis on quality, strength and simplicity of design and with routine care will give many years of trouble free operation.

The following instructions have been written to cover the use and maintenance of the machine. Care should be taken to ensure that you are referring to the correct section of your machine before carrying out any adjustments, or when ordering spare parts.

Like all mechanical products, regular cleaning, lubrication and maintenance will ensure a longer trouble free life. These instructions make no attempt to go beyond routine maintenance, and it is strongly advised that you contact your dealer should any major repairs become necessary.

Use only genuine service parts; non genuine parts may not meet standards required for safe and satisfactory operation.

Observe all safety information in the manual and on decals fitted to the machine and power unit.

Safety Instructions

1. Read and understand this operator's manual prior to operating the machine and keep it in a convenient place for future reference.
2. Keep untrained personnel away from the machine whilst it is in operation.
3. Keep all guards and safety devices in place.
4. Do not operate machine with guards removed.
5. Beware, pressured hydraulic oil can be very dangerous and can penetrate the skin - TAKE THE UTMOST CARE.
6. Keep hands, feet and loose clothing away from moving parts.
7. Always switch off the machine before making any adjustments or when carrying out lubrication and servicing.
8. Keep all nuts, bolts and fasteners tightened.
9. Check machine regularly for damaged or worn parts.
10. If the machine is left unattended ensure that it is locked or disabled to prevent use by untrained personnel.

Description

The pole jack is designed to remove telegraph poles from the ground. It uses a chain to grip the pole and hydraulic power to pull the pole out of the ground. It must be used in conjunction with a crane or similar to support the pole to prevent the pole falling over once loosened from the ground.

A foot pedal is available to control the Pole Jack where required. It consists of a hydraulic valve and pedal assembly to control the ram, plus 2 long hydraulic hoses so the operator can stand a safe distance from the pole being removed.

The Pole Jack is required to be attached to a hydraulic power pack source which must not produce in excess of **200 Bar** and **30 L/min** or damage may occur to the pole jack.

Important Notes

The unit is only suitable for use by trained operators using appropriate protective clothing.

This should include: **Safety Boots, High Visibility Jacket, Hard Hat, and Gloves.**

Do not adjust the relief valve, or use more than 30 Litre/min of oil flow. Autoguide can supply suitable valves if it is intended to operate the unit from power sources that exceed the maximum recommended pressure and flow limits (see above).

The Pole Jack, Base Plate and Chain must be used and kept as a kit. They all share a Serial Number and must be used in conjunction with each other.

All chain tags must be in good order, attached and visible.

The chain **MUST** be checked and inspected before and after every use for signs of wear and damage.

The chain **MUST** be formally checked and recorded weekly. The logs should stay with the vehicle.

The chain must have LOLER and or insurance checks every 6 months. The logs should be kept with the crane/vehicle certificates.

All chains with damage **MUST** be destroyed to prevent further use and replaced.

Any repairs to the system must be carried out by the manufacturer or a competent authorised company.

OPERATION OF THE POLE JACK

Operating Instructions

1. Place the baseplate with its 'cut-out' against the pole, making sure that there is adequate support underneath. (Voids should be filled before use.) Ensure the pole doesn't have blocks fitted.



2. Inspect the chain for any sign of wear or damage before use.



Note: The Chain Pt No: 04480 is specifically designed to work with this Pole Jack ONLY. It must not be used for any other lifting operation

3. Attach the hydraulic hoses between the Pole Jack and its power supply. NEVER operate the ram with only one hose connected. Cycle the ram through its full extents 10 times to remove any air from the system.



4. Place the chain around the pole, with the loose end through the reeveable link and pull tight.



5. Locate the ball-end of the jack into the socket of the base plate.



6. Locate the chain through the clutch plate on top of the pole jack. The chain must be sitting fully in the cut out with the next link perpendicular and fully seated on the curved face.

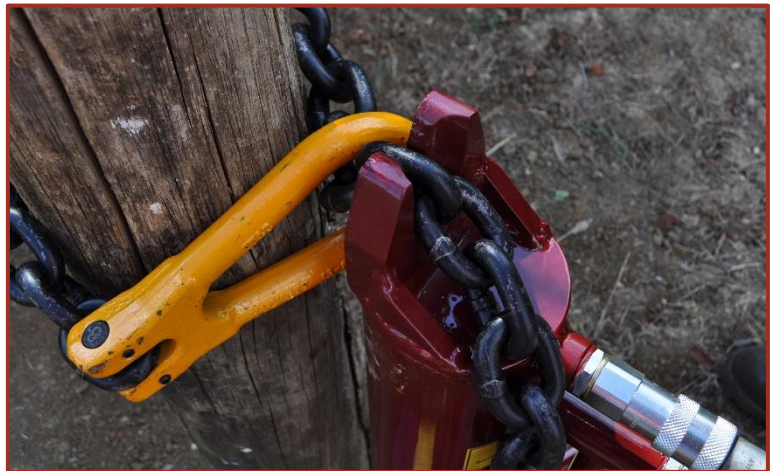

The images below show the chain fully engaged in the clutch plate. The chain link (left images) must be fully in the slot and the chain link (right images) be orientated correctly and have full contact with the hardened steel groove.

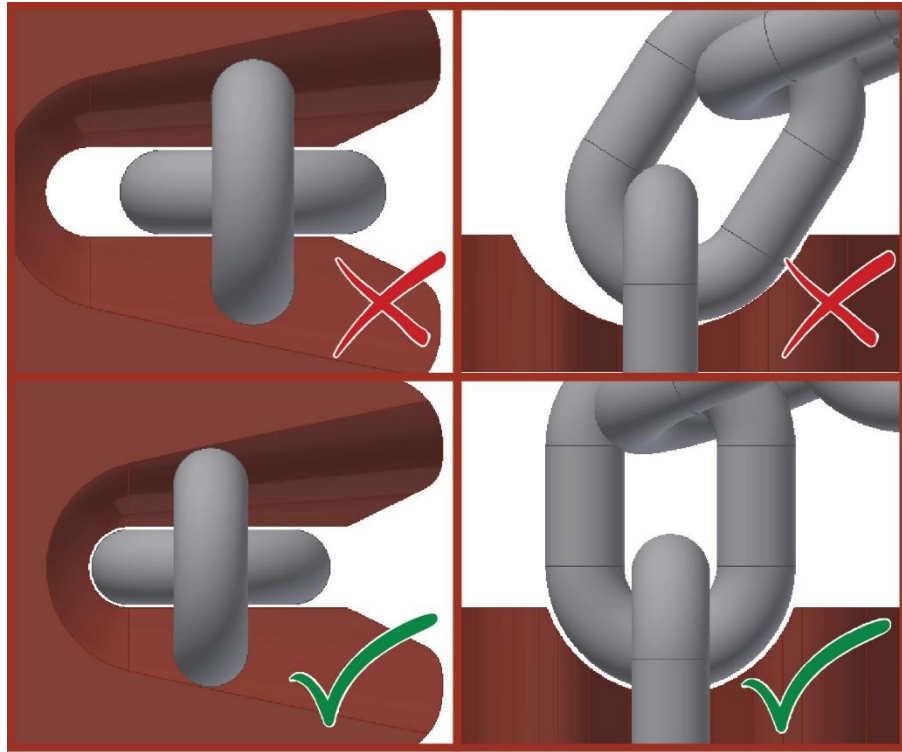

Note: The pole jack must be used in conjunction with a crane or similar that supports the pole, prior to extracting with the pole jack.

7. Ensuring all bystanders are clear, operate the hydraulic supply to extend the ram and extract the pole.
8. Retract ram and allow the chain to slide down the pole for the second pull.
9. Check the chain engagement in the clutch and repeat pull.



10. When complete, fully retract ram and then extend 10mm. Remove the pressure in the line and disconnect the couplers.



USING THE POLE JACK WITH THE FOOT PEDAL

Assembly

To control the pole jack with the foot pedal, the items including the hydraulic power pack need to be connected prior to use.

1. Place the foot pedal operating unit on stable level ground, outside the exclusion zone.
2. Ensure that the power-pack is within 3m of the foot pedal operating unit.
3. Ensuring that the hydraulic fittings are clean and free from dirt, connect the two long hydraulic hoses from the rear of the foot pedal operating unit to the ports on the power-pack.
4. Similarly, ensuring that the hydraulic fittings are clean and free from dirt connect the 2 hydraulic hoses from the pole jack to the 2 couplers on short leads of the foot pedal unit.

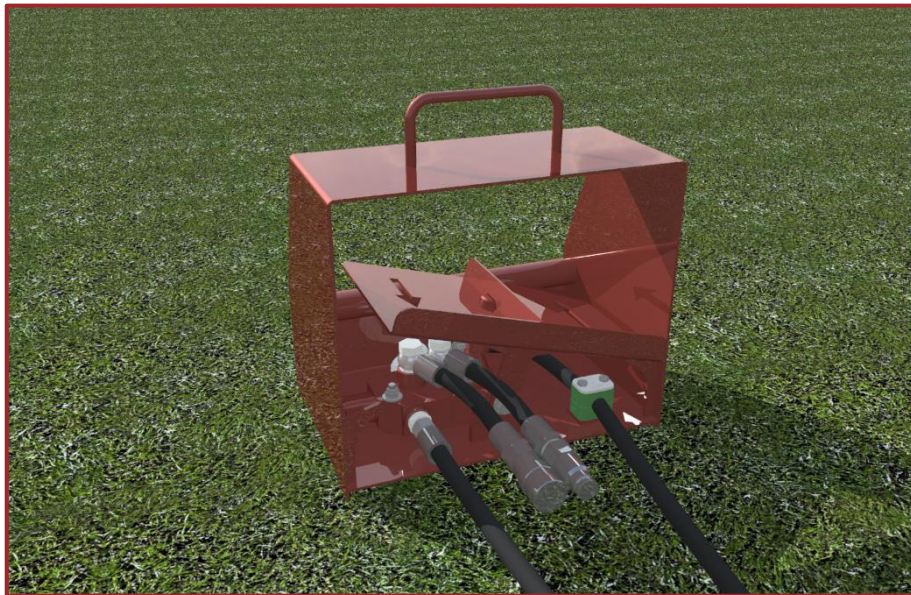

5. The circuit should look like:



Note: Do not connect the hoses in the wrong orientation as it may cause damage to the valve and powerhead.

Operating Instructions

To operate the Pole Jack:

1. Start the hydraulic power pack and switch on the hydraulic flow.
2. Follow the instructions on Page 5. The foot pedal is used to operate the Pole Jack by pressing on the appropriate pedal.

To disconnect the Pole Jack:

1. Fully retract ram and then extend 10mm.
2. Switch off the power pack
3. Operate the foot pedal in both directions to remove any remaining pressure in the pipes and Pole Jack.
4. Disconnect the hoses from the Pole Jack and Foot Pedal Unit.

TROUBLESHOOTING

Symptom	Possible Cause	Action
Jerky	Cold Oil	Allow time to warm up
	Air in Pipes	Check oil Level
	Non Compatible Quick Couplers	Use Matched pairs
Slow	Non Compatible Quick Couplers	Replace
	Hoses too small for flow	Replace
	Pump Failing	Carry Out flow and Pressure Check
Poor Performance	Oil Filter Blocked	Carry Out flow and Pressure Check
	Dirt Contamination	Service Exchange Motor
	Low Hydraulic Pressure	Carry Out Flow and Pressure Check
Oil leaks	Excessive Oil Temperature	Check Pump, Check Hose Sizes,
	Loose Fittings	Tighten Up Fittings
Oil leaks	Leaky Connections	Reseal or check Configuration
	Pressure Too High	Use compatible head and fittings

END OF LIFE

When the machine reaches the end of its useable lifetime it is important that the independent elements of the machine are reused, recycled or disposed of suitably.

Component	What to do?
Metals	All metals should be recycled with an appropriate scrap metal merchant, preferable sorted into metal type.
Electronics	All electrical components should be recycled at an appropriate facility according to the WEEE Directive and Regulations 2013
Oils	Oil waste is classed as Hazardous and therefore must be stored separately and according to legal regulations (that differ dependent on country). It must be disposed of by a suitable Waste Oil collection company.
Hydraulic Hoses	Hydraulic hoses should be drained of oil, metal ends removed and then recycled with a suitable specialist recycling company. Metal ends can be sent to metal recycling centers.
Plastics	All plastics should be sorted into recyclable and non-recyclable and then either sent to suitable recycling facilities or landfill.

SPARE PARTS LIST

50796 - Pole Jack

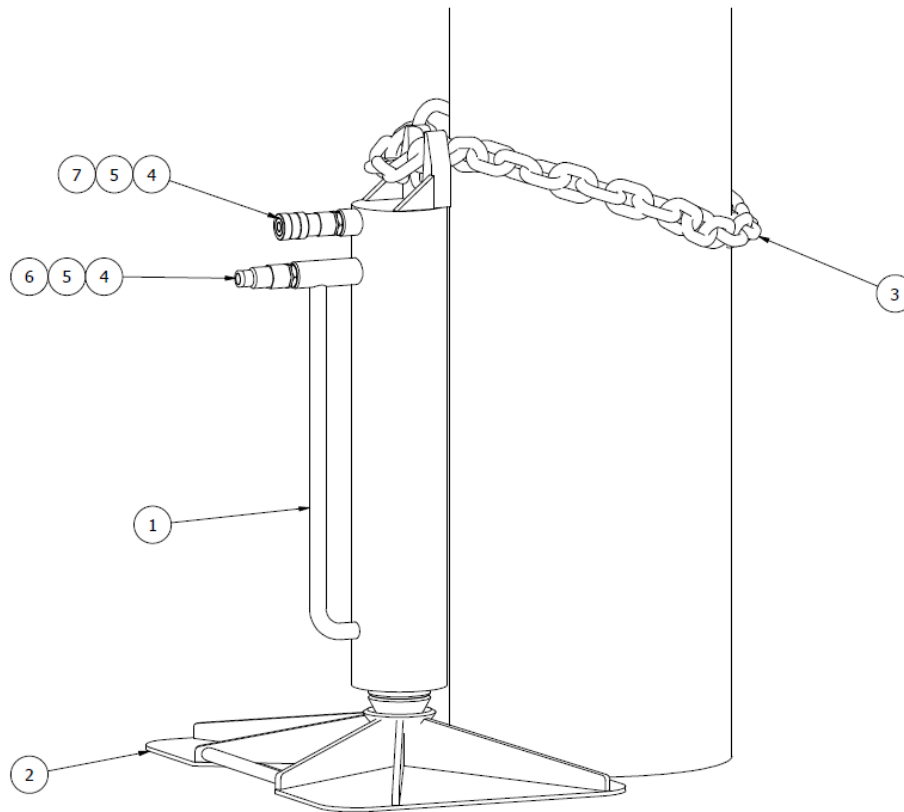

Code
50796

Description
Pole Jack Assembly

No.	Code	Description	Quantity
1	50785	Pole Jack Ram WA	1
2	25643	Pole Jack Base Plate WA	1
3	42700	Pole Jack Chain Assembly	1
4	01097	MM Adaptor	1
5	02182	Seal Bonded 008	1
6	09206	Quick Coupler FF Male	1
7	09191	Quick Coupler FF Female	1
8	52060	Pole Jack Stickers	1
9	52061	Union Jack Sticker	1

49235 – Foot Pedal Assembly

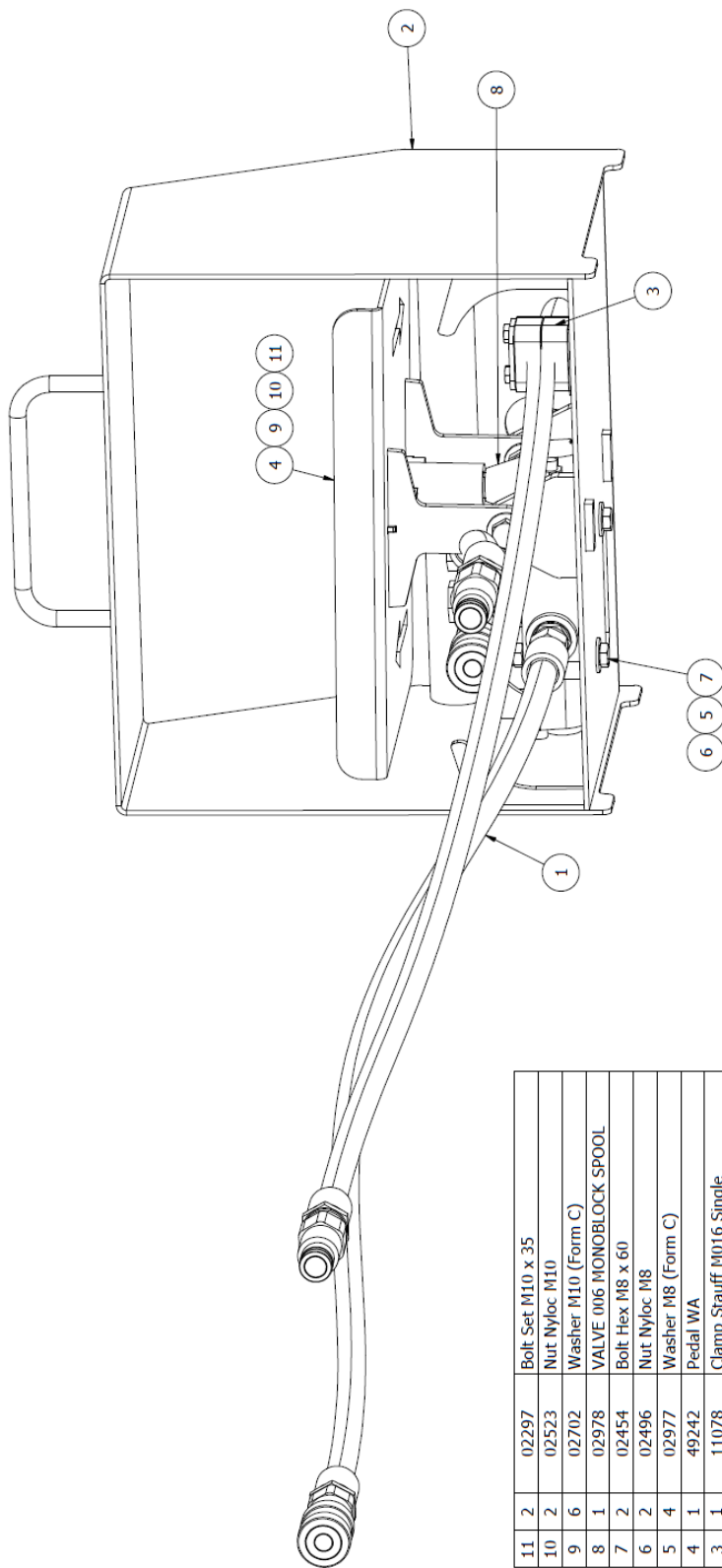

11	2	02297	Bolt Set M10 x 35
10	2	02523	Nut Nyloc M10
9	6	02702	Washer M10 (Form C)
8	1	02978	VALVE 0M6 MONOBLOCK SPOOL
7	2	02454	Bolt Hex M8 x 60
6	2	02496	Nut Nyloc M8
5	4	02977	Washer M8 (Form C)
4	1	49242	Pedal WA
3	1	11078	Clamp Stauff M016 Single
2	1	49237	Pedal Base WA
1	1	49236	Foot Pedal Hyd Assy

49236 – Foot Pedal Hydraulic Assembly

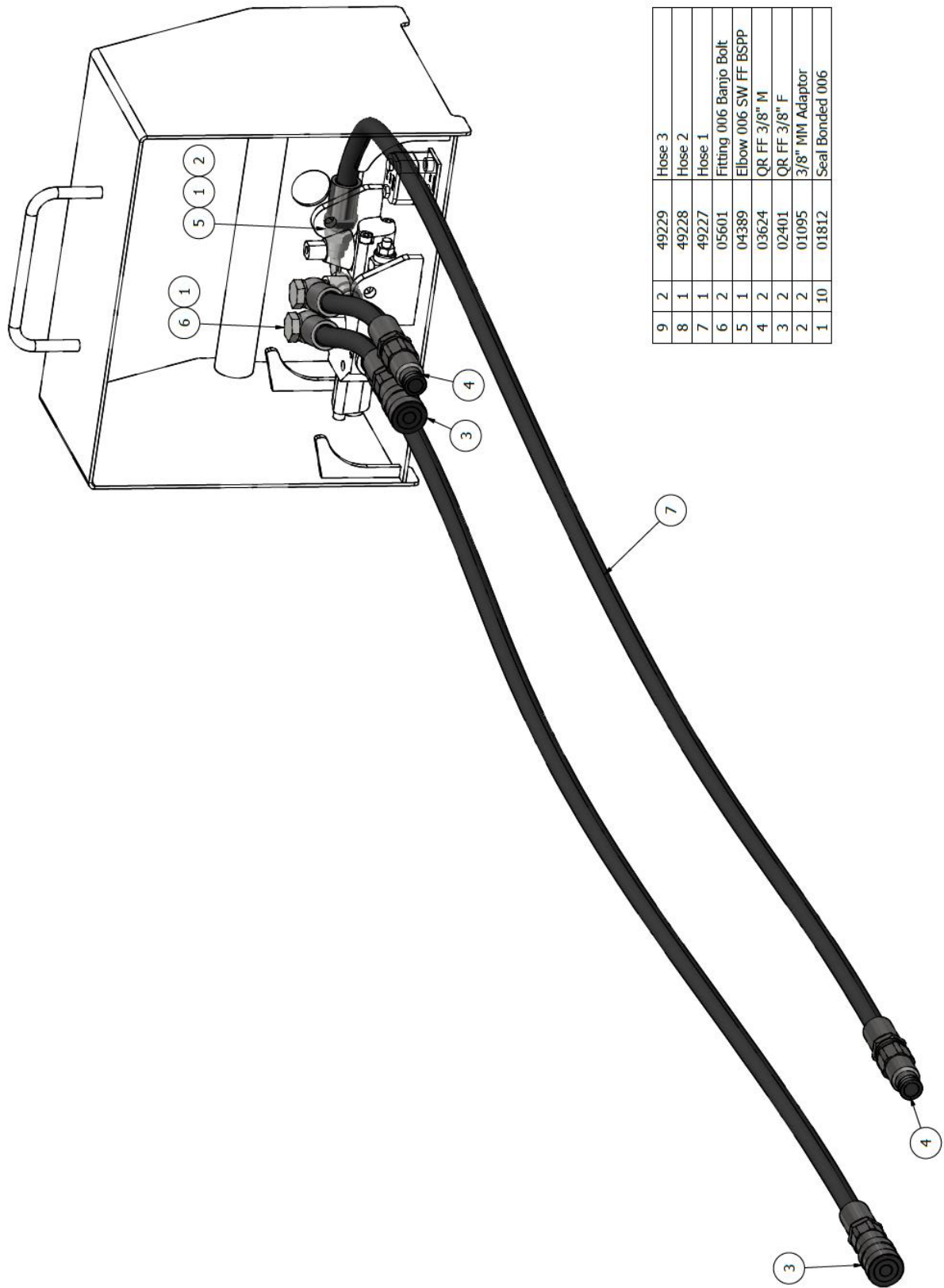

9	2	49229	Hose 3
8	1	49228	Hose 2
7	1	49227	Hose 1
6	2	05601	Fitting 006 Banjo Bolt
5	1	04389	Elbow 006 SW FF BSPP
4	2	03624	QR FF 3/8" M
3	2	02401	QR FF 3/8" F
2	2	01095	3/8" MM Adaptor
1	10	01812	Seal Bonded 006



Autoguide Equipment
Stockley Road
Heddington
Nr. Calne
Wiltshire SN11 0PS
England
Tel: +44 (0) 1380 850885
Website: www.autoguide.co.uk

